



WiiM Mini Hi-Res Audio Streamer

Model: WiiM Mini

CONTENTS

1. INTRODUCTION.....	3
2. WHAT'S IN THE BOX	3
3. SPEC	4
4. CONTROLS AND LIGHTS	6
5. HOW TO SET UP	7
5.1 CONNECT THE AUDIO CABLE	7
5.2 SETUP SYSTEM	8
5.3 FILL YOUR HOME WITH SOUND	9
6. VOICE CONTROL	10
6.1 WORKS WITH ALEXA.....	10
6.2 WORKS WITH SIRI	10
7 CONTROL VIA YOUR FAVORITE APP	11
7.1 SPOTIFY CONNECT	11
7.3 TIDAL CONNECT	12
8 ALL MUSIC IN ONE APP	13
9.1 LINKPLAY MULTI-ROOM/STEREO PAIRING	13
9.2 AVS MULTI-ROOM.....	13
10 CONNECTING VIA AUX IN.....	14
11 CONNECTING VIA AUX /SPDIF/BT OUT	14
11.1 CONNECTING VIA SPDIF/AUX OUT.....	14
11.2 CONNECTING VIA BT OUT.....	14
12 STREAM AUDIO WITH BLUETOOTH	15
13 ADVANCED FEATURES	15
13.1 UPDATE THE SPEAKER	15
13.2 DISABLE/ENABLE WI-FI.....	15
14 FAQ	15
IMPORTANT SAFETY INSTRUCTIONS.....	16
CE/FCC/IC STATEMENTS	17

1. INTRODUCTION

Our goal at WiiM is to provide you with the simplest, affordable, Hi-Fi, and lossless audio systems. With our patented audio streaming solution built into all our high-quality products and App, you will have the ease of playing music throughout your home. All our products are developed with the finest product design and intuitive user interface.

Meet WiiM Mini, a compact, versatile, and high-fidelity wireless music streamer. It delivers lossless audio, Apple AirPlay 2, Alexa, Spotify Connect, Amazon Music casting and TIDAL Connect to your stereo system. It streams music directly from the cloud of all major music services or your own library.

Just plug WiiM Mini into your stereo receiver, DAC or amplifier and control it directly from the free WiiM Home App, your favorite music apps such as Spotify, TIDAL and Amazon Music. Or, control it with your voice using iPhone, HomePod, compatible Echo device, and the Alexa App or Apple Home App.

WiiM Mini can be grouped with Homepod, Echo, other Alexa compatible devices or another WiiM Mini to stream music throughout your home. Or, play different songs in different rooms. With its digital and analog inputs and outputs, WiiM Mini works with your existing stereo system.

Turn your audio gear smart and hear your music in high fidelity and gapless with WiiM Mini from WiiM!

2. WHAT'S IN THE BOX

WIIM MINI USERMANUAL

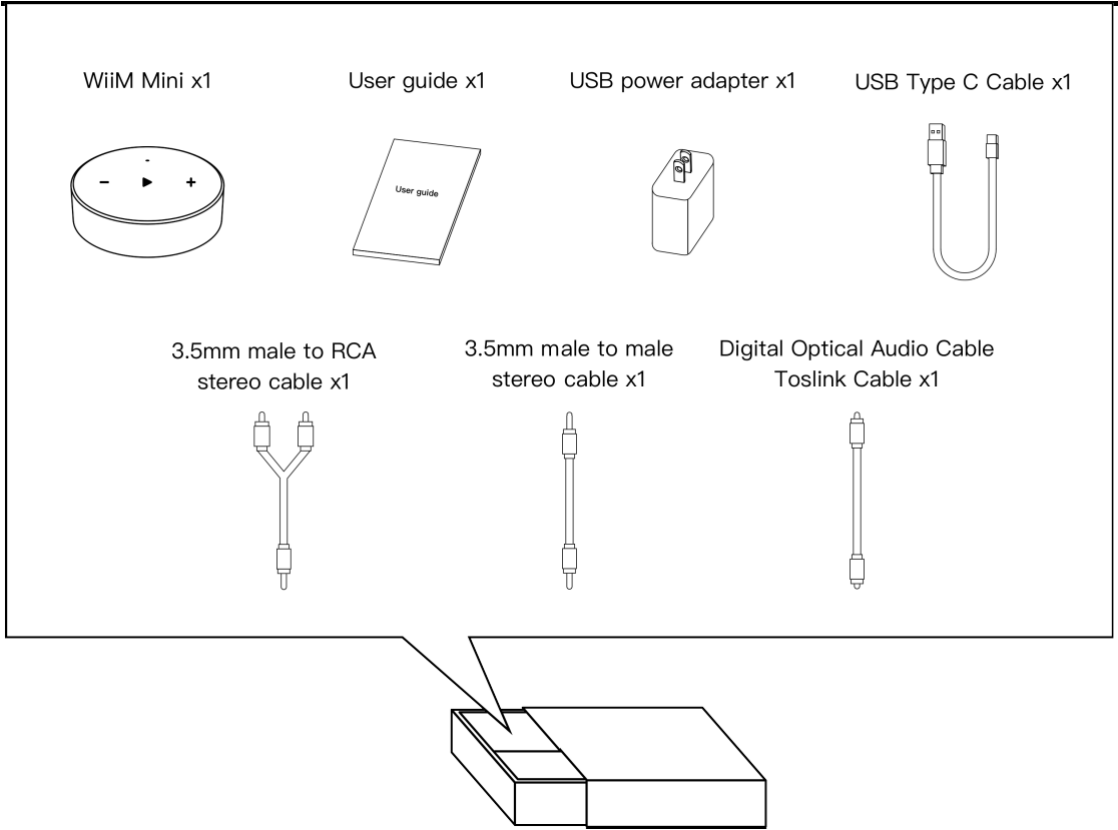

3. SPECS

Feature	Description
Audio Sound Quality	Audio Output: bit perfect output, up to 192 kHz, 24-bit
Wireless Network	802.11 b/g/n/ac 2.4 G and 5G dual bands
Bluetooth	Bluetooth 5.2
Audio input	1 x 3.5 mm Analog Aux input, 1Vrms, 48 kHz/16-bit (up to 24-bit)
Audio Output	1x3.5mm analog Aux output, 1x digital optical (SPDIF) output
Line out	Aux in to Aux out: Power Output=2Vrms THD+N Ratio=0.009% SNR=102dB Crosstalk=-106dB Dynamic Range=96dB BT in to Aux out:

WIIM MINI USER MANUAL

	Power Output=2Vrms THD+N Ratio=0.05% SNR=103dB Crosstalk=-107dB Dynamic Range=121dB
SPDIF	Aux in to SPDIF out: Power Output=-3dBFS THD+N Ratio=0.005% SNR=105dB Crosstalk=-103dB Dynamic Range=97dB
Power Input	USB Type-C, 5V_1A
Audio Codec	MP3, AAC, ALAC, APE, FLAC, WAV, WMA, OGG
Protocol	AirPlay 2, DLNA, Spotify Connect, TIDAL Connect, works with Alexa
Streaming Services	Spotify, Amazon Music, Deezer, Tunein, Tidal, Qobuz, iHeartRadio, Napster, Sound machine etc.
LED	Three color status LED - Red, Green and White
Button	Capacitive touch buttons – Play/Pause, Volume +, Volume -
Weight	1.4 oz (40 g)
Dimension	2.7 x 2.7 x 0.9 in (69 x 69 x 24 mm)

4. CONTROLS AND LIGHTS



BUTTONS AND CONTROLS PANEL

Function	
Play/Pause/Setup	Play/Pause, network pairing and restore to factory setting
Volume Up	Increase volume
Volume Down	Decrease volume
Analog audio in	-
Analog audio out	-
USB Type-C	USB Power Input
Digital Optical audio out	-
1 Amic	Used to auto-measure the audio path latency for AirPlay 2, Amazon Alexa multi-room, and LinkPlay multi-room sync etc.

LIGHTS

State	Color	Flashing/Solid
Boot-up	White	Flashing (fast)

WIIM MINI USER MANUAL

OOBE/Ready to Setup	White	Flashing (slow)
BT ready to pairing	Green	Flashing (slow)
Connecting to Wi-Fi	White, Green	Flashing (fast)
Connected to Wi-Fi	White	Solid
BT mode, paired	Green	Solid
Aux-in mode	Green	Solid
OTA	White, Green	Flashing (slow)
Restore to factory setting	White, Red	Flashing (slow)
No Network	Red	Solid
Faulty Error	Red	Flashing (slow)

NOTES:

WGR: Three color LED, no color mix

W: Wi-Fi (product default mode)

G: Other working mode

R: Error

Three modes: Solid, flashing slow, flashing fast

5. HOW TO SET UP

5.1 CONNECT THE AUDIO CABLE.

- ① If you're connecting to an audio/video receiver (AVR) or amplifier
or
- ② If you're connecting to powered speakers
or
- ③ If you're connecting to a computer

WIIM MINI USERMANUAL

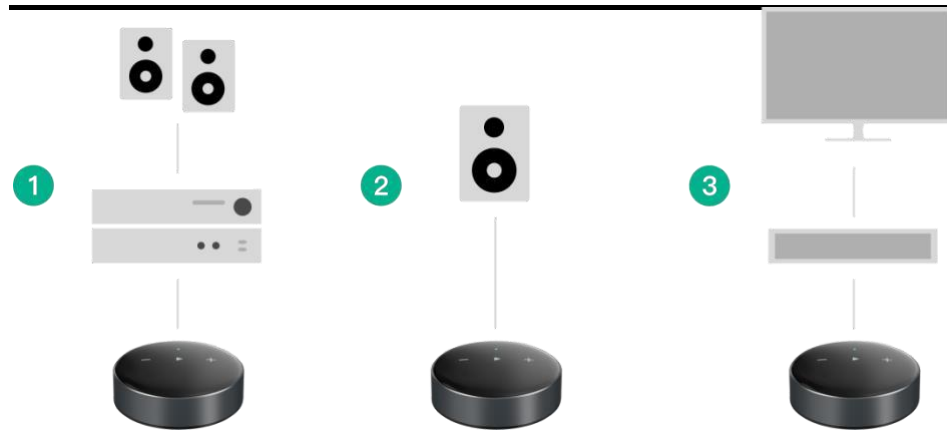

Attach the power cord and plug in your Mini.

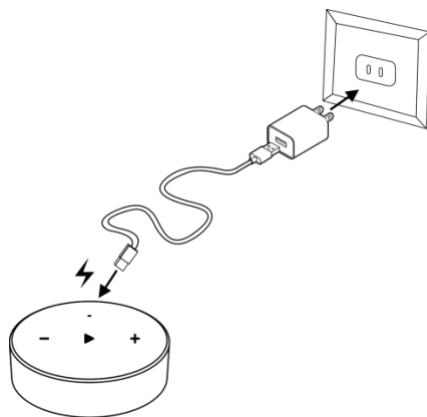

5.2 SETUP SYSTEM

- **Wi-Fi SETUP**
Download the WiiM Home App



- Power on speaker, audio/video receiver (AVR) or amplifier, or computer.
- Open the WiiM Home App.
- Click on the device you want to configure.
- Enter the correct password.

If you are using an **iOS system**, you can also use Apple Wireless Accessory Configuration (WAC) protocol or Home App to setup the device.

- **SETUP with Apple WAC**
 - Power on speaker, audio/video receiver (AVR) or amplifier, or computer.
 - Open iPhone settings and tap your selected device's name on the WAC setup section
- **SETUP with Apple Home App**
 - Tap the Home app located on the home screen of the iOS device.
 - Tap the "+" button located at the top-right corner of the screen.
 - Tap "Add Accessory."
 - Tap "Don't Have a Code or Can't Scan?"
 - Tap your selected device which **MUST** be listed under "Nearby Accessories."

5.3 FILL YOUR HOME WITH SOUND

Stream your favorite music, radio stations through Wi-Fi or Bluetooth. Having multiple WiiM Mini devices, you can stream music throughout the house. Or plug in a stereo component—like an amplified turntable, CD player, or MP3 player—and cast music to multiple WiiM Mini connected speakers at once.

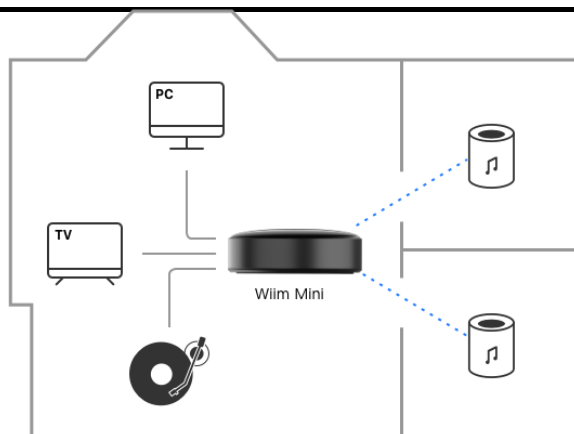

6. VOICE CONTROL

With Voice Control, you can navigate and interact with your device, using your voice to search, play, stop or skip music and more.

When Voice Control is configured, you can voice commands just like you would perform an action by touch.

6.1 WORKS WITH ALEXA

Download Amazon Alexa App and turn on Amazon devices or 3rd party Alexa built-in devices.

- ★ Configure one or more devices.

If your device is not logged into your Amazon account in the WiiM Home App.

- Open WiiM Home App, Click "Browse -> Amazon Alexa -> GetStarted"
- Log in to your Amazon account.
- Open the Amazon Alexa app and log in.

If your device is logged into your Amazon account in the WiiM Home App.

- Open the Amazon Alexa app and log in the same Amazon account as the WiiM Home app.

- ★ Click "Devices" at the bottom of the page.
- ★ Click "+" in the top right corner.
- ★ Click "Combine speakers ->Multi-room music"
- ★ Select the configured Echo (or other Amazon devices) and the configured WiiM mini device.
- ★ Click "Next" and choose the group name (Bedroom or other).
- ★ Amazon Alexa app prompt that the group has been created.
- ★ "Alexa, play some music in the Bedroom," then the Multi-room group playback can be controlled.

6.2 WORKS WITH Siri



- Configure one or more devices.
- Open a music app (like Apple Music) and select a track to play.
- Tap .
- Select your speaker/speakers or Home Pod.
- Say "Hey Siri, stop music/Play music" or touch the top of Home Pod to wake up Siri, say "Stop music/Play music".

7 CONTROL VIA YOUR FAVORITE APP

7.1 Spotify Connect

Spotify Connect is a way of playing Spotify through your wireless compatible device over wi-fi. That means you can play your favorite tunes anywhere in the house, all without the need for any convoluted Bluetooth pairing between devices every time you want to listen to music.



Use your phone, tablet, or computer as a remote control for Spotify. Go to spotify.com/connect to learn how.

The Spotify

Software is subject to third party licenses found here:

<https://www.spotify.com/connect/third-party-licenses>

7.2 AirPlay 2

The biggest feature of AirPlay 2 is multiroom audio.

It's Apple's first real move into multi-room technology, with AirPlay 2 finally letting you stream music from your iOS device to more than one product.

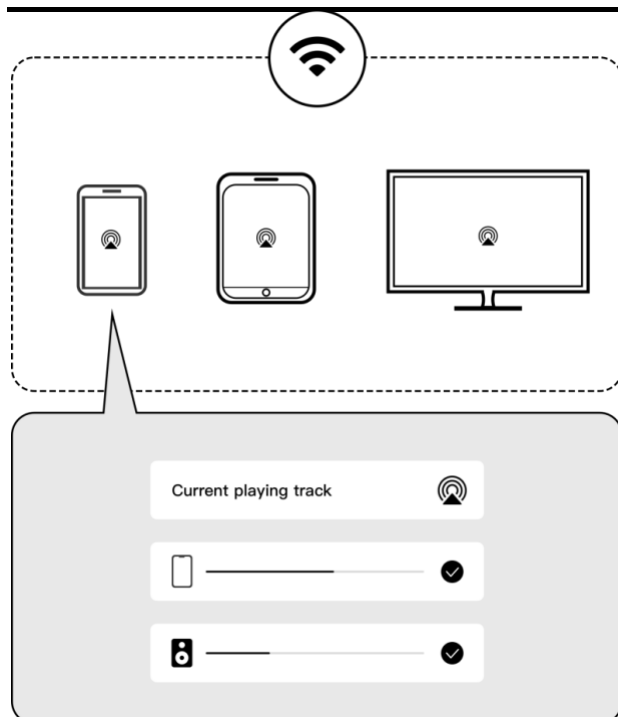

The WiiM Mini can play AirPlay 2 audio, which allows you to quickly stream audio from your Apple device to the external speaker or multiple speakers.

NOTES:

- To use AirPlay 2, you need an Apple device running iOS 11.4 or later.
- Your Apple device and WiiM mini must be connected to the same Wi-Fi network.
- For more information about AirPlay 2, visit: <https://www.apple.com/airplay>

STREAM AUDIO FROM THE CONTROL CENTER

1. On your Apple device, open the Control Center.
2. Tap and hold the audio card in the top-right corner of the screen, then tap the AirPlay icon .
3. Select your Wim Mini device.

STREAM AUDIO FROM AN APP

1. Open a music app (like Apple Music) and select a track to play.
2. Tap .
3. Select your WiiM Mini device.

7.3 Tidal Connect

TIDAL is a global music streaming platform bringing fans closer to artists through unique experiences and the highest sound quality. Stream your favorite music seamlessly from TIDAL App straight to your devices in the highest possible quality.

8. ALL MUSIC IN ONE APP

WiiM Mini learns your habits and provides you with customized service.

We support many popular music streaming services in our companion app like Tidal, Calm Radio, Qobuz, SoundMachine, vTuner, and through Amazon Voice Service like Spotify, iHeartRadio, Amazon Prime Music, Napster, Deezer & more to come.

8 MULTIROOM and Stereo Pairing

With the WiiM Mini connected stereo system, it's easy to build your wireless multiroom sound system with other AirPlay 2 speakers or Amazon Echo. You can create more flexible multiroom sound system with multiple WiiM Minis and your existing audio devices. All types of audio input including Wi-Fi, Bluetooth, and Auxiliary can be used as the audio source for the multiroom system.

In addition, you can group two speakers connected with WiiM Minis as a stereo pair for a wider, more immersive sound stage.

Thus, it can work with almost your every music listening options.

8.1 Linkplay MULTIROOM/STEREO PAIRING

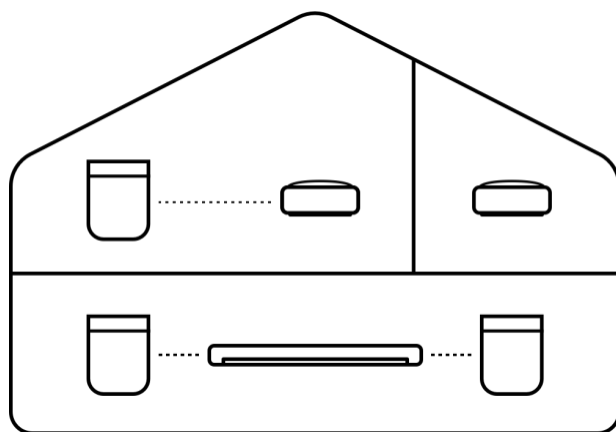

- Configure two or more devices.
- Open WiiM Home App.
- Select the device and click the plus sign in the upper right corner“+”
- Select the other WiiM Mini, click “Done”
- Click the LR icon“L” and set the device to "L/R/LR"
- In the Browse Tap, play “My music” or others.

8.2 AVS MULTIROOM

TIP: Download Amazon Alexa App and get ready with Echo or other Amazon devices.

For detailed steps please refer to 6.1.

9 . CONNECTING VIA AUX IN

WiiM Mini can be used as wireless WiFi transmitter that can stream the analog audio input from CD player, recorder, or computer to another (or multiple) WiiM Mini connected device.

To set up the WiiM Mini with the Aux input:

1. Plug the 3.5mm cable into the Aux in port on the back of the WiiM Mini.
2. Plug the other end of the cable into the record player.
3. In the WiiM Home app, Go to Browse > Select source on device > Aux in, select the Aux in for audio distribution.
4. Create a multiroom music group with your WiiM Mini. On WiiM Home app, Go to Devices, select the WiiM Mini connected with your Aux-in device. Tap the group button (with + sign in a box) in the top right corner of the device box. Select the WiiM Mini you wish to connect with.

Once completed, the music playing from the device plugged into the WiiM Mini will play to your multiroom music group.

10 . CONNECTING VIA AUX /SPDIF/BT OUT

There are two ways to control your volume. To enable the fixed line-out level, please select it from the device setting on WiiM Home App.

- Control volume from your AVR or amplifier (Fixed volume output)
- Control the volume from WiiM Home App

Note: To achieve bit perfect output, please choose 'fixed volume output' from the device setting.

10.1 CONNECTING VIA SPDIF/AUX OUT

- Depending on the output you prefer to use, plug the SPDIF line /RCA or 3.5 mm (1/8 ") end of the cable into the corresponding output port on the source device or preamplifier.
- Open the WiiM Home App on your iOS or Android device.
- Start playing on the source device.

10.2 CONNECTING VIA BT OUT (BT sourcing mode)

- Open the WiiM Home App on your iOS or Android device.
- In the **Browse**  Tab, switch to Bluetooth mode.
- Connect Bluetooth to an external power amplifier (Support Bluetooth).
- Start playing on the source device.

11 . STREAM AUDIO WITH BLUETOOTH

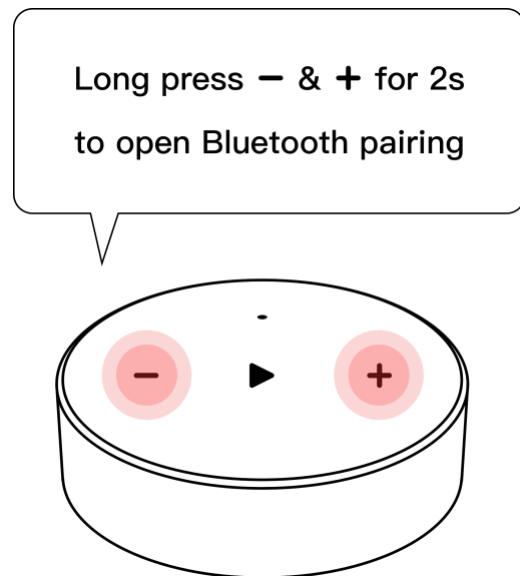

Bluetooth wireless technology lets you stream music from mobile devices such as smartphones, tablets, and laptop computers. Before you can stream music from a device, you must connect your device to the speaker.

12 . ADVANCED FEATURES

12.1 UPDATE THE SPEAKER

- The speaker updates automatically when connected to the WiiM Home app and to your Wi-Fi network.
- Upgrade from 2:00-5:00 a.m. During the silent upgrade, there should be no sound and no indication.

12.2 ENABLE WIFI SETUP MODE

Press and hold Play/Pause for 3s to enable WIFI setup mode.

13 . FAQ

If you are experiencing problems with the audio streamer, try these solutions first:

- What can I do if I cannot find device?
Ensure that the network is available, and the device is powered on properly.
Restart the device.
Check the LED on the device is solid white.
If not, reconfigure the device to the network.

- What can I do if my device has no sound?
Ensure that the power amplifier is powered on normally.
Ensure that the 3.5mm (1/8 ") end of the cable and optical fiber line is working properly and the interface is not loose.
Make sure the amplifier and equipment are at a normal audible volume.
- What can I do if my device cannot power on normally?
Check the device status and ensure that the power cable works properly.
(More FAQs can be found on our website: <https://wiim.freshdesk.com/a/solutions>)

SUPPORT

If you are unable to resolve your issue, please check our support and send us an email about your issues as below:

WiiM Mini App: Settings/FAQ

Website: wiimhome.com/FAQ

Email: support@Wiimhome.com

Product User Guides: wiimhome.com/guide

RESET THE SPEAKER

Press and hold play/pause for 10s, afterwards you will hear the voice tone and see the light flashing red.

Factory reset clears all source, volume, and network settings from the speaker and returns it back to the original factory settings.

IMPORTANT SAFETY INSTRUCTIONS

IMPORTANT, RETAIN FOR FUTURE REFERENCE: READ CAREFULLY

1. Read these instructions.
2. Keep these instructions.
3. Heed all warnings.
4. Follow all instructions.
5. Do not use this apparatus near water.
6. Clean only with a dry cloth.
7. Do not block any ventilation openings. Install in accordance with the manufacturer's instructions.
8. Do not install near any heat sources such as radiators, heat registers, stoves, or other apparatus (including amplifiers) that produce heat.
9. Protect the power cord from being walked on or pinched particularly at plugs, convenience receptacles, and the point where they exit from the apparatus.
10. Only use attachments/accessories specified by the manufacturer.
11. Unplug this apparatus during lightning storms or when unused for long periods of time.
12. Refer all servicing to qualified personnel. Servicing is required when the apparatus has been damaged in any way, such as external power supply, power-supply cord or plug is damaged, liquid has been spilled or objects have fallen into the apparatus, the apparatus has been exposed to rain or moisture, does not operate normally, or has been dropped

WIIM MINI USERMANUAL

13. To reduce the risk of fire or electrical shock, do NOT expose this product to rain, liquids or moisture.
14. Do NOT expose this product to dripping or splashing, and do not place objects filled with liquids, such as vases, on or near the product.
15. Keep the product away from fire and heat sources. Do NOT place naked flame sources, such as lighted candles, on or near the product.
16. Do NOT make unauthorized alterations to this product.
17. Do NOT use in vehicles or boats.
18. Use this product only with the power supply provided.
19. Where the mains plug or an appliance coupler is used as the disconnect device, the disconnect device shall remain readily operable.
20. Due to ventilation requirements, does not recommend placing the product in a confined space such as in a wall cavity or in an enclosed cabinet.
21. Contains small parts which may be a choking hazard. Not suitable for children under age 3.
22. This product contains magnetic material. Consult your physician on whether this might affect your implantable medical device.
23. Do not place or install the bracket or product near any heat sources, such as fireplaces, radiators, heat registers or other apparatus (including amplifiers) that produce heat.

CE/FCC/IC Statements

FCC Statement:

This device complies with part 15 of the FCC rules. Operation is subject to the following two conditions:

- (1) this device may not cause harmful interference, and
- (2) this device must accept any interference received, including interference that may cause undesired operation.

NOTE: The manufacturer is not responsible for any radio or TV interference caused by unauthorized modifications or changes to this equipment. Such modifications or changes could void the user's authority to operate the equipment.

NOTE: This equipment has been tested and found to comply with the limits for a Class B digital device, pursuant to part 15 of the FCC Rules. These limits are designed to provide reasonable protection against harmful interference in a residential installation. This equipment generates uses and can radiate radio frequency energy and, if not installed and used in accordance with the instructions, may cause harmful interference to radio communications. However, there is no guarantee that interference will not occur in a particular installation. If this equipment does cause harmful interference to radio or television reception, which can be determined by turning the equipment off and on, the user is encouraged to try to correct the interference by one or more of the following measures:

- Reorient or relocate the receiving antenna.
- Increase the separation between the equipment and receiver.
- Connect the equipment into an outlet on a circuit different from that to which the receiver is connected.
- Consult the dealer or an experienced radio/TV technician for help.

Federal Communication Commission (FCC) Radiation Exposure Statement

When using the product, maintain a distance of 20cm from the body to ensure compliance with RF exposure requirements.

FCC ID: 2ANOG-ASR001

CE Statement:

RF exposure information: The Maximum Permissible Exposure (MPE) level has been calculated based on a distance of d=20 cm between the device and the human body. To maintain compliance with RF exposure requirement, use product that maintain a 20cm distance between the device and human body.

Do not use the device in the environment at too high or too low temperature, never expose the device under strong sunshine or too wet environment.
The suitable temperature for the product and accessories is 0°C-40°C.

Operating Frequency Range, Max Output Power

Bluetooth: 2402MHz ~ 2480MHz, 9.28dBm

WLAN 2.4GHz: 2412MHz ~ 2472MHz, 17.18dBm

WLAN 5GHz: 5150MHz ~ 5825MHz, 15.96dBm

The device for operation in the band 5150~5350 MHz is only for indoor use to reduce the potential for harmful interference to co-channel mobile satellite systems.

	AT	BE	BG	CH	CY	CZ	DE	DK
	EE	EL	ES	FI	FR	HR	HU	IE
	IS	IT	LI	LT	LU	LV	MT	NL
	PL	PT	RO	SE	SI	SK	TR	UK(NI)
	UK							

This product can be used across EU member states.

EU Regulatory Conformance

Hereby, Linkplay Technology Inc. Corporation declares that this device is in compliance with the essential requirements and other relevant provisions of Directive 2014/53/EU.

For the declaration of conformity, visit the Web site <https://wiimhome.com/guides>



WIIM MINI USER MANUAL

IC Statement:

This device complies with Industry Canada licence-exempt RSS standard(s). Operation is subject to the following two conditions:

- (1) this device may not cause interference, and
- (2) this device must accept any interference, including interference that may cause undesired operation of the device.

Under Industry Canada regulations, this radio transmitter may only operate using an antenna of a type and maximum (or lesser) gain approved for the transmitter by Industry Canada. To reduce potential radio interference to other users, the antenna type and its gain should be so chosen that the equivalent isotropically radiated power (e.i.r.p.) is not more than that necessary for successful communication.

Radiation Exposure Statement:

This equipment complies with IC radiation exposure limits set forth for an uncontrolled environment. This equipment should be installed and operated with minimum distance 20cm between the radiator & your body.

The device for operation in the band 5150–5250 MHz is only for indoor use to reduce the potential for harmful interference to co-channel mobile satellite systems.

Le présent appareil est conforme aux CNR d'Industrie Canada applicables aux appareils radioexempts de licence. L'exploitation est autorisée aux deux conditions suivantes (1) l'appareil ne doit pas produire de brouillage, et

(2) l'utilisateur de l'appareil doit accepter tout brouillage radioélectrique subi, même si le brouillage est susceptible d'en compromettre le fonctionnement. Conformément à la réglementation d'Industrie Canada, le présent émetteur radio peut fonctionner avec une antenne d'un type et d'un gain maximal (ou inférieur) approuvé pour l'émetteur par Industrie Canada. Dans le but de réduire les risques de brouillage radioélectrique à l'intention des autres utilisateurs, il faut choisir le type d'antenne et son gain de sorte que la puissance isotrope rayonnée équivalente (p.i.r.e.) ne dépasse pas l'intensité nécessaire à l'établissement d'une communication satisfaisante.

Déclaration d'exposition aux radiations:

Cet équipement est conforme aux limites d'exposition aux rayonnements IC établies pour un environnement non contrôlé. Cet équipement doit être installé et utilisé avec un minimum de 20 cm de distance entre la source de rayonnement et votre corps.

IC: 30828-ASR001